

three inches = one foot
 one and one half inches = one foot
 one inch = one foot
 three quarter inch = one foot
 one half inch = one foot
 three eighth inch = one foot
 one eighth inch = one foot

NOTES

1. DUCTS TO BE SOUNDLINED 3' UPSTREAM AND DOWNSTREAM OF PINCH BOXES.
2. FLEX DUCT LENGTH NOT TO EXCEED FIVE FEET.
3. COMPLY WITH IMC SECTION 5.10 DUCT CONSTRUCTION AND MANUFACTURING.
4. ALL NON-LAB SPACES TO BE SERVED BY AV BOXES OF A SIZE TO MATCH INCOMING SUPPLY DUCT.
5. EXHAUST DIFFUSERS IN EACH ROOM SHALL HAVE SAME CFM AS TOTAL OF SUPPLY DIFFUSERS, EXCEPT WHERE NOTED. ALL EXHAUST DIFFUSERS SHALL BE MARK RG-PA, PG-PB, RG-PC, RG-PD, OR RG-PE AND SELECTED SO THAT NECK SIZE MATCHES THE DUCT SIZE SHOWN ON THE DRAWING.
6. SEE DETAILS FOR MANUAL VOLUME DAMPER IN THE BRANCH DUCT SERVING EACH SUPPLY OR EXHAUST DIFFUSER.
7. LAB FUME HOOD EXHAUST DUCT TO BE 316L STAINLESS STEEL. DUCT TO HAVE 2-HOUR FIRE WRAP ONCE IT HAS PENETRATED THE FIRE BARRIER.
8. LAB SPACES WITH FUME HOODS TO BE PROVIDED WITH VENTURI AIR CONTROL VALVES ON EXHAUST AND RETURN. OTHER LAB SPACES AND ALL SUPPLY TO BE SERVED WITH EITHER VENTURI VALVE OR CONSTANT VOLUME PRESSURE INDEPENDENT VALVE.

KEY NOTES

- 1 MAKE DUCT CONNECTION TO CHEMICAL STORAGE CABINET, EACH AT 20 CFM CW CVR-6.
- 2 MAKE DUCT CONNECTION TO SMOKE/LEAK OR WASHER EXHAUST, CW CVR-6.
- 3 MAKE DUCT CONNECTION TO SMOKE/LEAK, CW CVR-8.
- 4 MAKE DUCT CONNECTION TO SMOKE HOOD.
- 5 LOWER AIR FLOW RATE WHEN FUME HOOD IS ON.
- 6 14x10 CAPPED FOR FUTURE FUME HOOD (650 CFM CW 80).
- 7 PROVIDE 2HR FIRE RATED ENCLOSURE OR FIRE-WRAP TO DUCT TO EXTENT SHOWN.

- A RG-PA 100 CFM
- B SD-PA 115 CFM
- C RG-PA 90 CFM
- D SD-PA 50 CFM
- E RG-PA 40 CFM

KEY PLAN

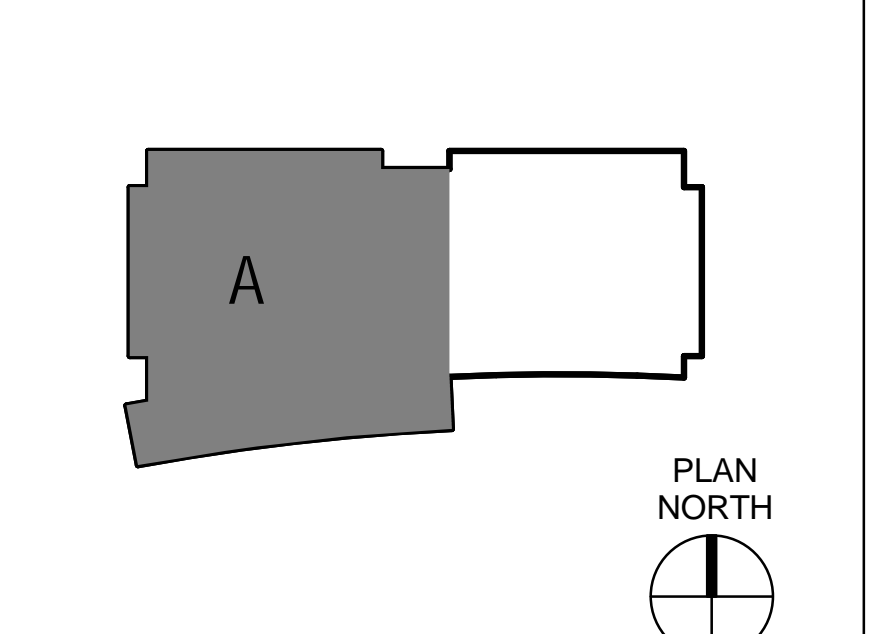

CONSTRUCTION DOCUMENT 2
 FULLY SPRINKLERED

AMENDMENT A00004	07.14.2014
AMENDMENT A00002	06.19.2014
BID DOCUMENTS	05.30.2014
CONSTRUCTION DOCUMENT CD2	06.05.2013

CONSULTANTS:

Stantec Consulting
 100 California Street, Suite 1000
 San Francisco, CA 94111
 T: 415.882.9500
 F: 415.882.9523

ARCHITECT

STANTEC | THE DESIGN PARTNERSHIP

Drawing Title	MH&R - LEVEL 3, SECTOR A HVAC FLOOR PLAN
Drawing Scale	1/8" = 1'-0"
Approved: Project Director	

Project Title	Building 101 Mental Health Services VAPSHCS Seattle Division - Phase 2 MENTAL HEALTH AND RESEARCH BUILDING
Location	1660 South Columbian Way, Seattle, WA 98105
Date	JUNE 05, 2013
Checked	
Drawn	
Project Number	VAF 663-405B
Building Number	B101 Mental Health Services
Drawing Number	MH131
Volume 2b	

Office of
 Construction
 and Facilities
 Management

Department of
 Veterans Affairs